

D.S.S.PAL NAINITAL PUBLIC SCHOOL
Ramgarh Road, Shyamkhet, Bhowali (Nainital)-263132
Measurement Detail

<u>S. No.</u>	<u>Particular</u>	<u>Size in Sq.Mtr. (Round Off)</u>	<u>Size in Sq.Ft. (Round Off)</u>
1	Covered Area Block-1	242	2611
2	Covered Area Block-2	102	1099
(A)	Total Covered Area (Block1+Block2)	344	3710
3	Play Ground Area (Play Ground 1 Volleyball Ground)	162	1744
4	Play Ground Area (Play Ground 2)	561	6039
(B)	Total Area of Play Ground	723	7783
(C)	Other Un-Covered Area	175	1880
Total Area of Land as per Record		1242	13373

Roomwise Detail

<u>S.No.</u>	<u>Room Detail</u>	<u>Size Sq.Mtr. Round Off</u>	<u>Size Sq. Ft Round Off</u>
1	6 Room (8x6)M (Class 5th to 10th)	48	517
2	2 Room (8X6) (Optional Subject Room/Liabrary)	48	517
3	1 Room (9X5)M (Common Room)	45	484
4	2 Room (9X6)M (Science Lab)	54	581
5	2 Room (4.60X4.10)M (Administrative Room)	19	205
6	6 Room (5.60X5.10)M (Pre-Primery to 4th)	29	312
7	2 Room (5X4)M (Other Room)	20	215
8	2 Toilet (1.5X2)M	3	32
9	2 Toilet (1.5X3)M	4.5	48

विशेषी अधिकारी
 नगर पालिका परिषद
 भवाली (नैनताल)

मुख्य निष्ठा अधिकारी
 नगर पालिका परिषद (नैनताल)

संजय जोशी
 सभासद, वार्ड सं०-६
 नगर पालिका परिषद भवाली

ARPAN BAIN
 B.Arch.
 CA/2000/27013

नगर पालिका परिषद

D.S.S.PAL NAINITAL PUBLIC SCHOOL RAMGARH ROAD, SHYAMKHET, BLOCK-RAMGARH, DISTT.- NAINITAL (UTTARAKHAND)

LAYOUT PLAN
BLOCK 1

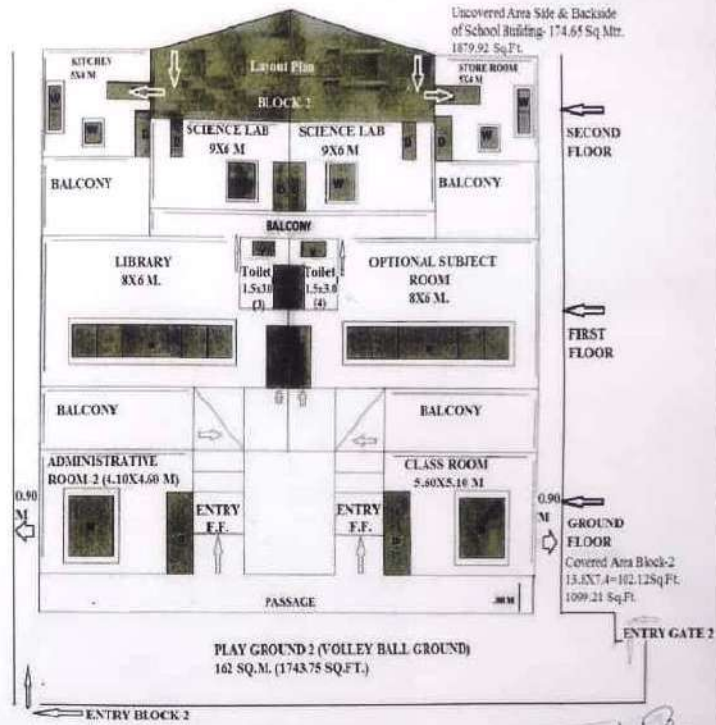
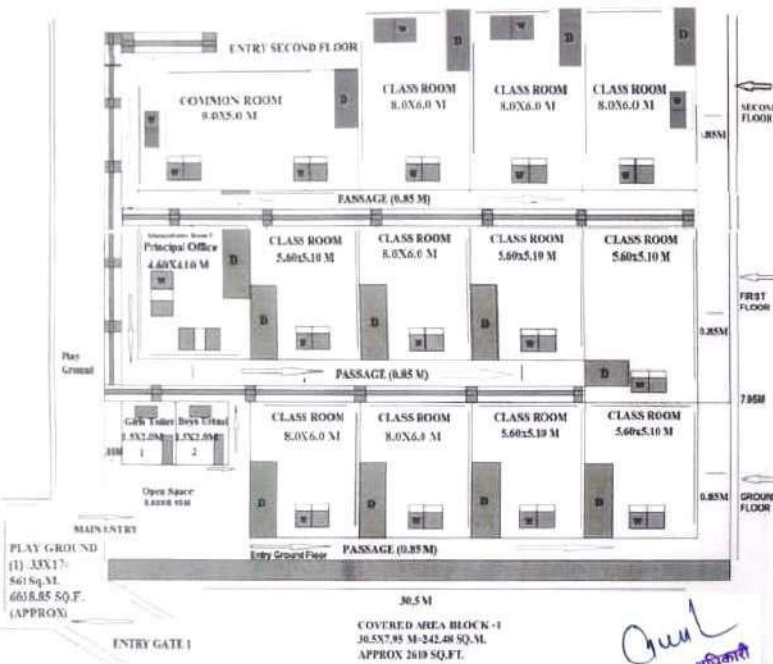

Roomwise Detail			
S.No.	Room Detail	Size Sq. Mtr. Round Off	Size Sq. Ft. Round Off
1	6 Room (8x6)M (Class 5th to 10th)	48	517
2	2 Room (8X6) (Optional Subject Room/Library)	48	517
3	1 Room (9X5)M (Common Room)	45	484
4	2 Room (9X6)M (Science Lab)	54	581
5	2 Room (4.60X4.10)M (Administrative Room)	19	205
6	6 Room (5.60X5.10)M (Pre-Primary to 4th)	29	312
7	2 Room (5X4)M (Other Rooms)	20	215
8	2 Toilet (1.5X2)M	3	32
9	2 Toilet (1.5X3)M	4.5	48

Arul
सुपुंड प्रिका अधिकारी
रामगढ़ (नैनीताल)

संयोजक
सभासद, वार्ड नं०-५
नगर पालिका परिषद भवाली

Arul
अभिषेकी अधिकारी
नगर पालिका प.र.
भवाली (नैनीताल)

संयोजक
नगरपालिका परिषद
भवाली (नैनीताल)

ARPAW JAIN
B.Arch.
C/2000/27013

1. ALL DIMENSION ARE IN FEET, INCHES & MM.
2. THIS DRAWING SHOULD BE READ IN CONJUNCTION WITH RELEVANT ARCHITECTURAL AND SERVICE DRAWING ANY DISCREPANCY SHOULD BE IMMEDIATELY BROUGHT TO NOTICE.
3. GRADE OF CONCRETE SHALL BE M-25.
4. GRADE OF STEEL SHALL BE Fe-550 TMT.

ARCHITECTS :-
|| PRATIBHA ||
Mehragan, Bhimtal,
Nainital (UK), INDIA.
PH: +91 9917194640, 9720455290
E MAIL: efficientarch@yahoo.co.in

ग्राम अथवा क्षेत्र की संख्या - 9
 पंचायत - महकमाती तहसील
 जिल्ला - डोंगीताल
 गांव का क्षेत्र 68 वर्ग = 9 बीघा
 का. 9884-86 वर्ग अर्थात् आवक
 9884

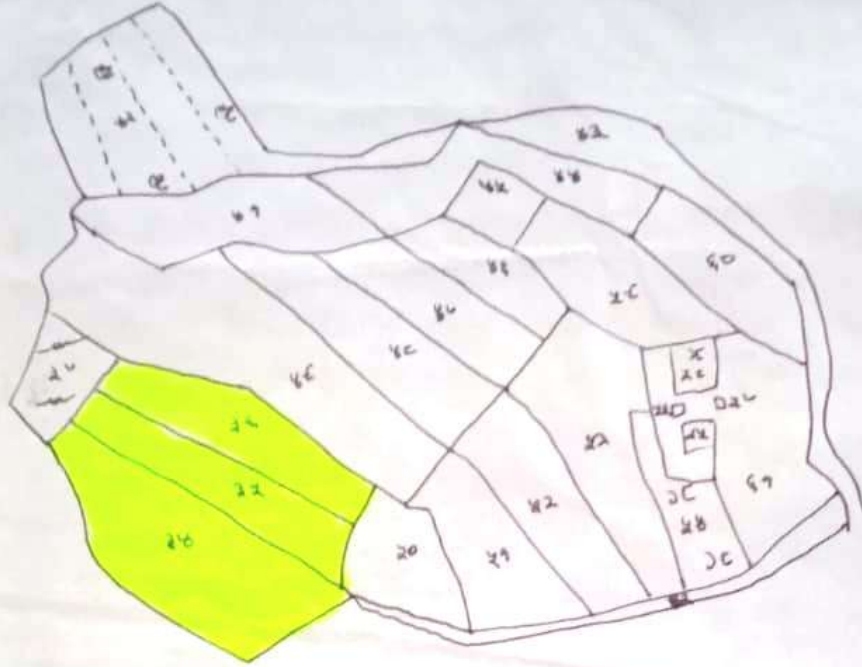

आवक पत्र की संख्या 10
 आवक क्रमांक 1814
 आवक पत्र की तिथि 31/5/26
 आवक पत्र की तिथि 31/5/26
 आवक पत्र की तिथि 31/5/26
 आवक पत्र की तिथि 31/5/26

मकल कर्ता
 मिलाज कर्ता
 शर्तों की संख्या 10

तल्लू प्रति
 पेशकार
 मूमि अभिलेख (10)

